

ITEM NO.	PART NUMBER	DESCRIPTION	DRAWING #	Default/QTY
1	BO-1/2x1-1/2 SHCS	BOLT SOCKET HEAD 1/2x1-1/2	STOCK	2
2	BO-1/2 FW	FLAT WASHER 1/2	STOCK	2
3	BO-.3125x2x5 U BOLT	BOLT 5/16x2x5 SQ	95-2217	2
4	BO-3/8x1 HCS	HEX BOLT 3/8x1	STOCK	4
5	BO-3/8 FW	FLAT WASHER 3/8"	STOCK	4
6	BO-3/8 LW	LOCK WASHER 3/8	STOCK	4
7	FP-EL-HF-COVER	ELECTRIC FEEDER ADAPTER BOX WLDMT.	30-1410	1
8	FP-HF12-22A	LIFT BRACKET BAR	30-2223	2
9	HF-EL HUB .753 ID	WELDED HUB .753 I.D ELECTRIC FEEDER	30-1412	1
10	HF-HF-1200	HYDRA-FEEDER 1200	30-1210	1
11	HF-KHF-A EXT	AUGER EXTENSION HYDRA FEEDER	30-1409	1
12	HF-KHF-DISC8	HYDRA-FEEDER 8" DISCHARGE KIT	30-1408	1

BOM IS FROM HF-PBEL  
SEE DWG # 30-1803  
FOR MORE DETAILS

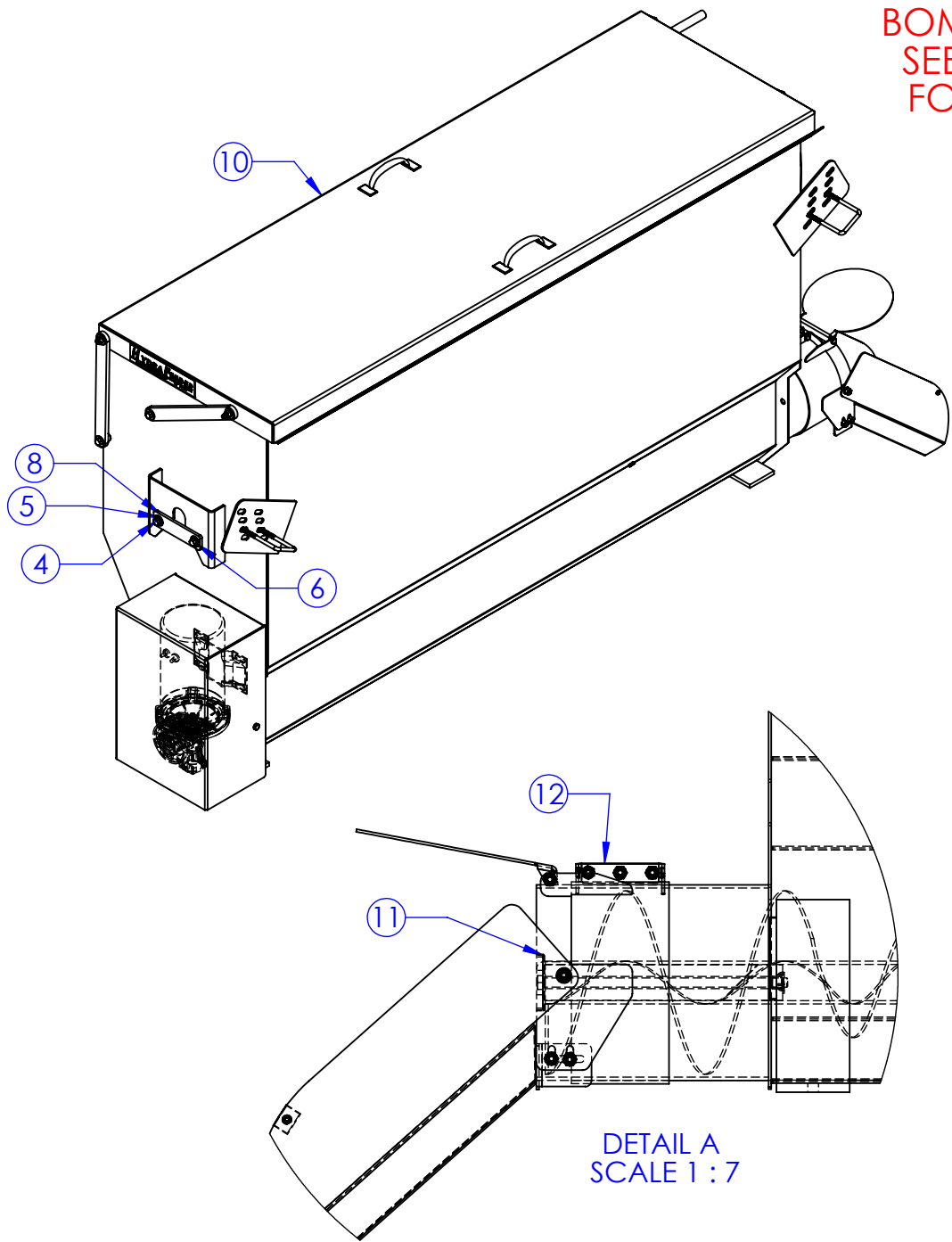

DETAIL A  
SCALE 1 : 7

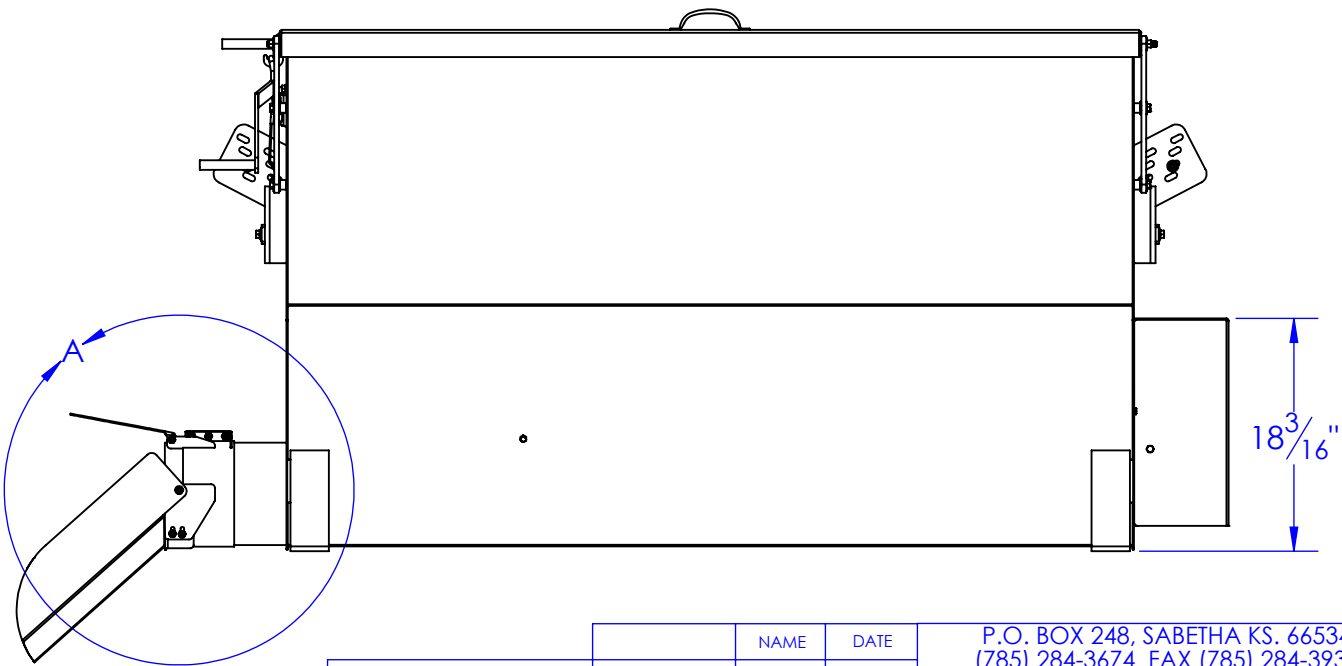
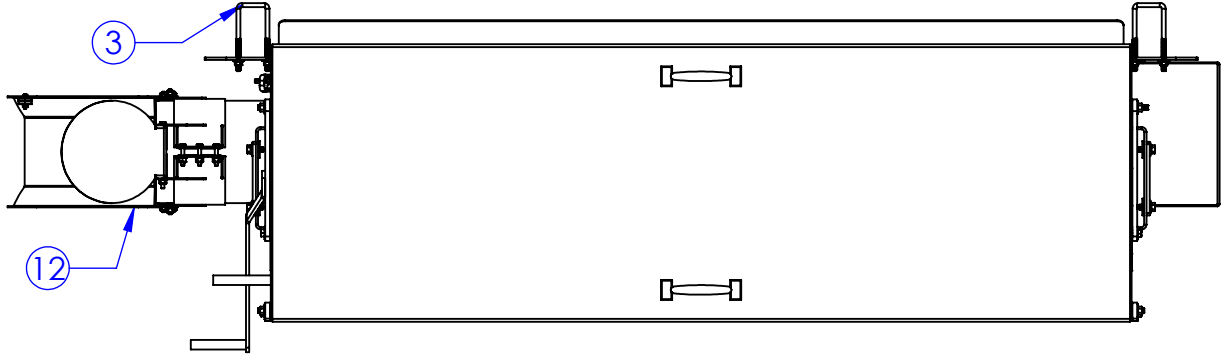
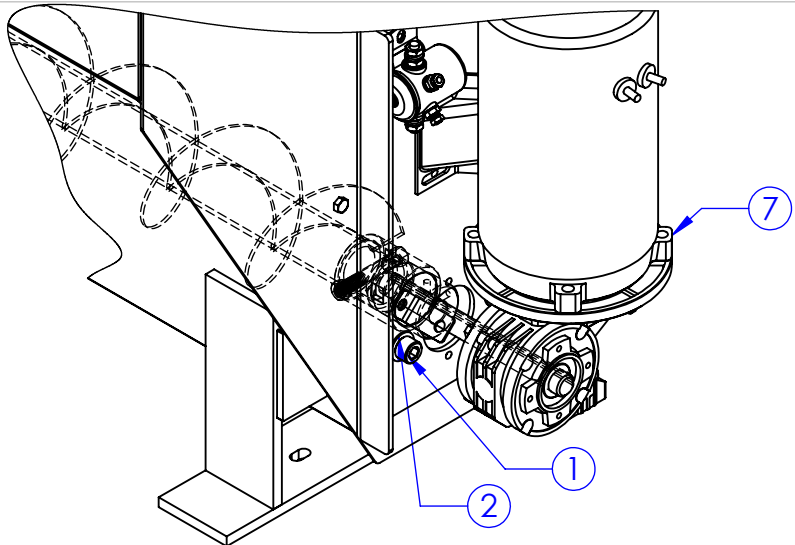
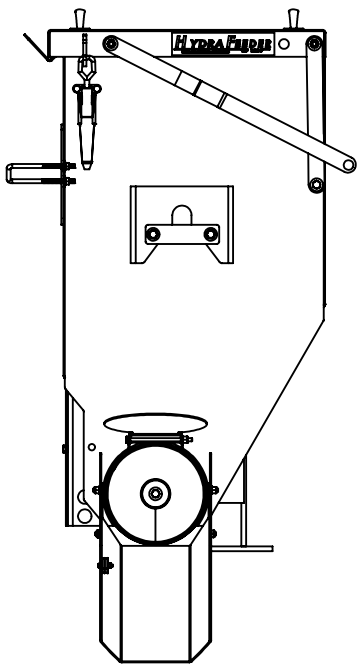

PROPRIETARY AND CONFIDENTIAL  
THE INFORMATION CONTAINED IN THIS  
DRAWING IS THE SOLE PROPERTY OF  
<INSERT COMPANY NAME HERE>. ANY  
REPRODUCTION IN PART OR AS A WHOLE  
WITHOUT THE WRITTEN PERMISSION OF  
<INSERT COMPANY NAME HERE> IS  
PROHIBITED.

UNLESS OTHERWISE SPECIFIED:  
DIMENSIONS ARE IN INCHES  
TOLERANCES:  
FRACTIONAL ±1/16  
ANGULAR: MACH ± 1 BEND ±  
TWO PLACE DECIMAL ±010  
THREE PLACE DECIMAL ±005  
MATERIAL  
DO NOT SCALE DRAWING

DRAWN	NAME	DATE	P.O. BOX 248, SABETHA KS. 66534 (785) 284-3674 FAX (785) 284-3931	
PART #	HEATH	10/2/2013	<b>TRIPLE C</b> INC.	
ASM #			SIZE <b>B</b>	DWG. NO. <b>30-0212</b>
COMMENTS: FINAL ASSEMBLY HF1200 ELECTRIC FEEDER			SCALE: 1:15	REV <b>A</b>
			WEIGHT: 496.26	SHEET 1 OF 1